



ALPHA

USER MANUAL



User manual
Stairlift "Alpha"

Version: April 2023

Lehner Lifttechnik GmbH
Salling 8
4724 Neukirchen am Walde
Austria

Tel.: +43 7278 3514 15
Fax.: +43 7278 3514 12
Email: office@lehnerlifttechnik.at
Web: www.lehner-lifttechnik.at



Have a look in
the user video
of the **Alpha**
stairlift

CONTENT

1	Introduction	1
2	Attention - safety first	2
2.1	Signs and symbols used	2
2.2	Operator of the stairlift	3
2.3	User group.....	3
2.4	Range of application.....	3
2.5	Qualified workers.....	3
2.6	Decommissioning	3
2.7	Intended use	4
2.7.1	Safety instructions.....	4
2.7.2	Use of the stairlift.....	5
3	Technical equipment	6
3.1	Schematic representation	6
3.2	Technical specifications.....	8
4	Safety devices	9
4.1	Armrests	9
4.2	Contact bottom.....	9
4.3	Lateral covers on the drive and carriages	9
4.4	Emergency stop (optional)	9
4.5	On/Off switch.....	9
4.6	Alarm button (optional)	9
4.7	Speed limiter and safety gear	9
4.8	Battery charging system	10
4.8.1	The beeper	10
5	Operating Elements	11
5.1	The main power switch.....	11
5.2	Operating elements	11
6	Operation of the lift	12
6.1	Automatic footrest function	13
6.2	Calling and sending the stairlift.....	13
6.3	Rotating the seat with a manual swivel seat.....	14
6.4	Rotating the seat with the automatic swivel seat.....	15
6.5	Passing through an intermediate stop with automatic swivel seat.....	16

7	Folding rail	16
7.1	Journey from the lower to the upper stop	16
7.2	Journey from the upper to the lower stop	16
7.3	Emergency release of the folding rail.....	17
8	Malfunction and troubleshooting	18
9	Movement of the lift with emergency handwheel.....	20
10	Control and maintenance	21
10.1	Security checks	21
10.2	Cleaning	21
11	Maintenance / inspection.....	22
11.1	Review	22
11.2	Maintenance instructions	22
11.2.1	Stairlift controls.....	22
11.2.2	Mechanics of the swivel seat, footrest and armrests	22
11.2.3	Contact base and contact-sensitive covers	23
11.2.4	Safety gear / Speed limiter	23
11.2.5	Rails / rack	23
11.2.6	Carriage rollers.....	23
11.2.7	Fastening of the rail and the supports	23
11.2.8	Mechanical switches	23
11.2.9	Gearbox and drive motor	24
11.2.10	Signalling equipment	24
11.2.11	Documents / Emergency release key.....	24
11.3	Lubricants and operating fluids, spare parts	24
11.3.1	Lubricants and operating fluids.....	24
11.3.2	Spare parts	24
12	Installation and commissioning	25
12.1	Fixing the rail system	25
12.2	Dismantling and disposal	25
13	CE declaration of conformity.....	26
14	Duties of the stairlift operator	27
15	Requirements for the maintenance company.....	28
16	Assembly and maintenance records.....	29

2 INTRODUCTION

We would like to congratulate you on the purchase of a stair lift from Lehner Liftechnik GmbH and welcome you to our large circle of satisfied customers. For more than 30 years, our lifts have been known as reliable means of transport, which are characterised by individual adaptation to structural conditions.

The *Alpha* stairlift represents a new generation of seated stairlifts with proven technology. The lift has been built according to the currently valid European safety rules.



As with any appliance that operates under load and whose parts are in motion, the utmost attention is required. Please read this user manual carefully. Make sure that every user of the lift has read and understood the user manual before using the lift. You will find instructions for operating the unit as well as safety instructions.

It must always be ensured that an instructed person is available next to the user. In order to ensure the rescue of persons in case of emergency (e.g. technical defect), the user must be able to reach this person easily. If an emergency call system is installed to summon help, it must be checked regularly, but at least once a week, to ensure that it is functioning properly. If external help is summoned (e.g. by telephone), an access facility must be provided for the summoned help personnel."

Use these instructions to benefit from Lehner Liftechnik's many years of experience in the operation of stairlifts. Proper care of the system on your part as well as scheduled maintenance by a competent company will provide you with a reliable lift system over a long period of time.

Lehner Liftechnik GmbH and its authorised partner companies offer you a comprehensive maintenance programme specifically for your installation, precisely adapted to its operation. Take advantage of the manufacturer's experience to achieve the highest possible efficiency for your stairlift system.

Keep these operating instructions for future reference.

Lehner Liftechnik GmbH expressly disclaims any liability for breakdowns caused by disregard of these instructions, non-compliance with the safety instructions or incorrect handling.

We hope you enjoy using the *Alpha* stairlift!

3 ATTENTION - SAFETY FIRST

This manual also contains instructions for emergencies. It must therefore be ensured that this manual is always available at the installation and kept accessible to the operator, lift attendant, rescue and maintenance personnel.

Please carefully observe the following points/regulations:

3.1 Signs and symbols used

The following signs enable you to become aware of important points immediately. This makes it much easier to use the operating instructions.



All passages marked with this sign require special attention. They are notes for smooth operation or important recommendations.



Warning: In the case of text passages with this sign, failure to observe the procedure indicated may lead to dangerous situations, causing personal injury or damage to property. Therefore, read these points with special care.



Text passages with this symbol refer to actions that must not be carried out under any circumstances. In case of non-observance, there is immediate increased danger, whereby personal injury or damage to property may occur.



All pictures, photos and drawings used in this manual are symbolic only and may differ from reality.

3.2 Operator of the stairlift

At least one responsible person must be appointed for each stair lift; this person must be easily accessible during the operating time of the installation. The installation must be maintained in a safe condition. If the installation is found to be unsafe, it must be taken out of service immediately; danger points must be secured. Accidents must be reported immediately to the expert (lift inspector or installation company) or the manufacturer.

The person in charge must satisfy themselves weekly that there are no obvious operationally dangerous defects and that the tasks listed in the chapter "Duties of the stairlift operator" are being carried out carefully.

3.3 User group

The stairlift may only be used by competent, qualified and responsible persons who are familiar with the system. The user must be able to take responsibility for himself and for third parties.

Persons who do not meet these requirements, as well as children, may only be transported by accompanying persons who also assume responsibility for the person being transported.

3.4 Range of application

The stairlift may only be used on stairs or accessible ramps. It is recommended to install the system in predominantly dry rooms. The ambient temperature must not be below -15 °C or above + 40°C. This type is not suitable for use in unusual locations (e.g. explosive areas, areas with aggressive media, etc.).

Outdoor use is possible in principle, however, in the case of outdoor installations that are exposed to the weather, it may be necessary to clear parts of the installation of ice and snow in winter on a case-by-case basis.

3.5 Qualified workers

Installation, maintenance, repairs and checks must be carried out by qualified persons, preferably by companies authorised by Lehner Liftechnik.

3.6 Decommissioning

When the unit is taken out of service for cleaning, maintenance or repair work, it must be protected against unintentional movement. The key switches on the call stations must be switched off and the keys removed.

3.7 Intended use

Preventive checks and regular maintenance of the system are highly recommended and guarantee you long-term, safe functioning.

3.7.1 Safety instructions

Observe the following points for correct use:



- The stairlift is designed exclusively for transporting one person seated on the seat provided.
- Never ride standing on the seat (risk of injury to the head, risk of falling).
- The stair lift is not intended for load transport.
- Always lock the stairlift so that it cannot be operated by unauthorised persons (e.g. children playing).
- Adhere to the specified maximum loads.
- The system must be maintained and safety-checked at the prescribed intervals.
- Passers-by going up or down the stairs must avoid any contact with the stairlift. Stairlift users must always be aware of pedestrians or other obstacles.



- Do not use the stairlift in case of fire! There could be a power failure during the ride and the user would be trapped.
- Never exceed the permissible payload! The payload is indicated on the type plate.
- Never bring your hands or loose clothing near the track or the back of the stairlift when the lift is in motion. Passengers must remain in the seat throughout the ride.
- Do not open the armrests while driving or outside of landings.
- Do not activate the manual swivel lever for turning the seat during driving or outside of landings.
- Do not disable any safety device by making mechanical or electrical changes to the installation. Without the written consent of Lehner Liftechnik, all types of adjustments and/or modifications to the system are prohibited.
- The stair lift may only be used by one person at a time. Accompanying persons are not allowed on the stair lift under any circumstances. Otherwise there is a risk of falling.

3.7.2 Use of the stairlift

The stairlift may only be used if it is in technically perfect condition. Any malfunction that could affect safety must be avoided or eliminated.

Report anything unusual to your service engineer. Do not use the stairlift if there are any irregularities or unusual noises - call the service immediately. All instructions and advice from experts, fitters and service personnel must be followed.



Before entering the up or down command, make sure that no one is endangered by the movement of the system. Always look in the direction of travel!

The transport of goods is only permitted if sufficient stability is ensured so that they cannot slip or fall over.

Also, keep the keys in a safe place and do not give them to unauthorised persons. Do not leave the keys on the vehicle or at the call stations when the lift is not in use.

It must always be ensured that an instructed person is available next to the user. In order to ensure the rescue of persons in case of emergency (e.g. technical defect), the user must be able to reach this person easily. If an emergency call system is installed to summon help, it must be checked regularly, but at least once a week, to ensure that it is functioning properly. If external help is summoned (e.g. by telephone), an access facility must be provided for the summoned help personnel.



In the **user video of our Alpha stairlift** we show you the correct use of your lift.

4 TECHNICAL EQUIPMENT

The *Alpha* stairlift is designed to transport people with reduced mobility. It is driven by a rack and pinion on the bottom rail. The lift is powered by 2 x 12 V batteries which are charged at the stops (as long as the power supply unit is powered).

The standard version is supplied with a manually folding footboard as well as manual swivel seat. The lift can be operated from 2 radio remote controls in the stops and from the control on the seat.

4.1 Schematic representation

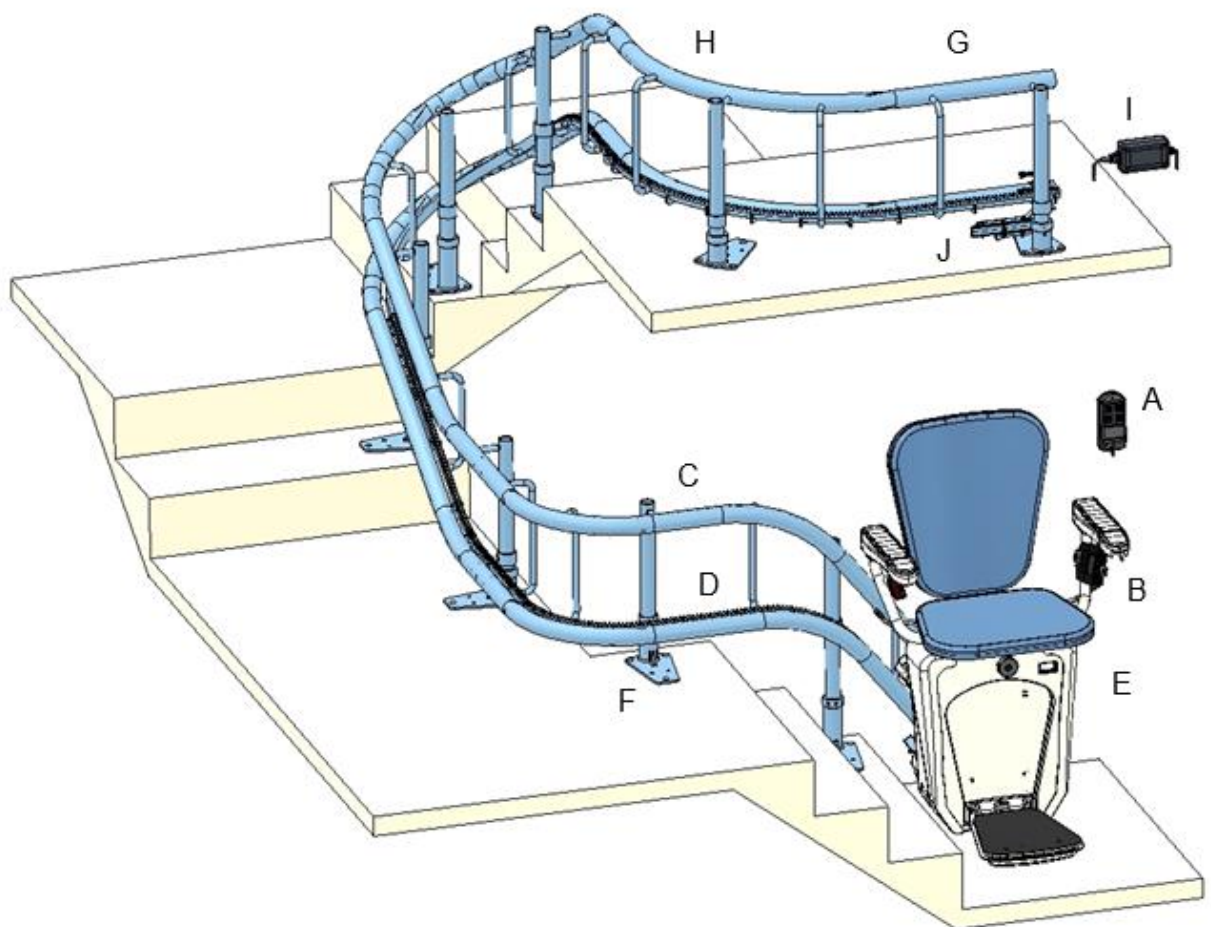

- | | | | |
|----|--------------|----|--------------------------|
| A) | Call station | F) | Base plate of the post |
| B) | Seatbelt | G) | Upper stop |
| C) | Upper rail | H) | Horizontal parking curve |
| D) | Lower rail | I) | Charger |
| E) | Lower stop | J) | Upper loading curve |

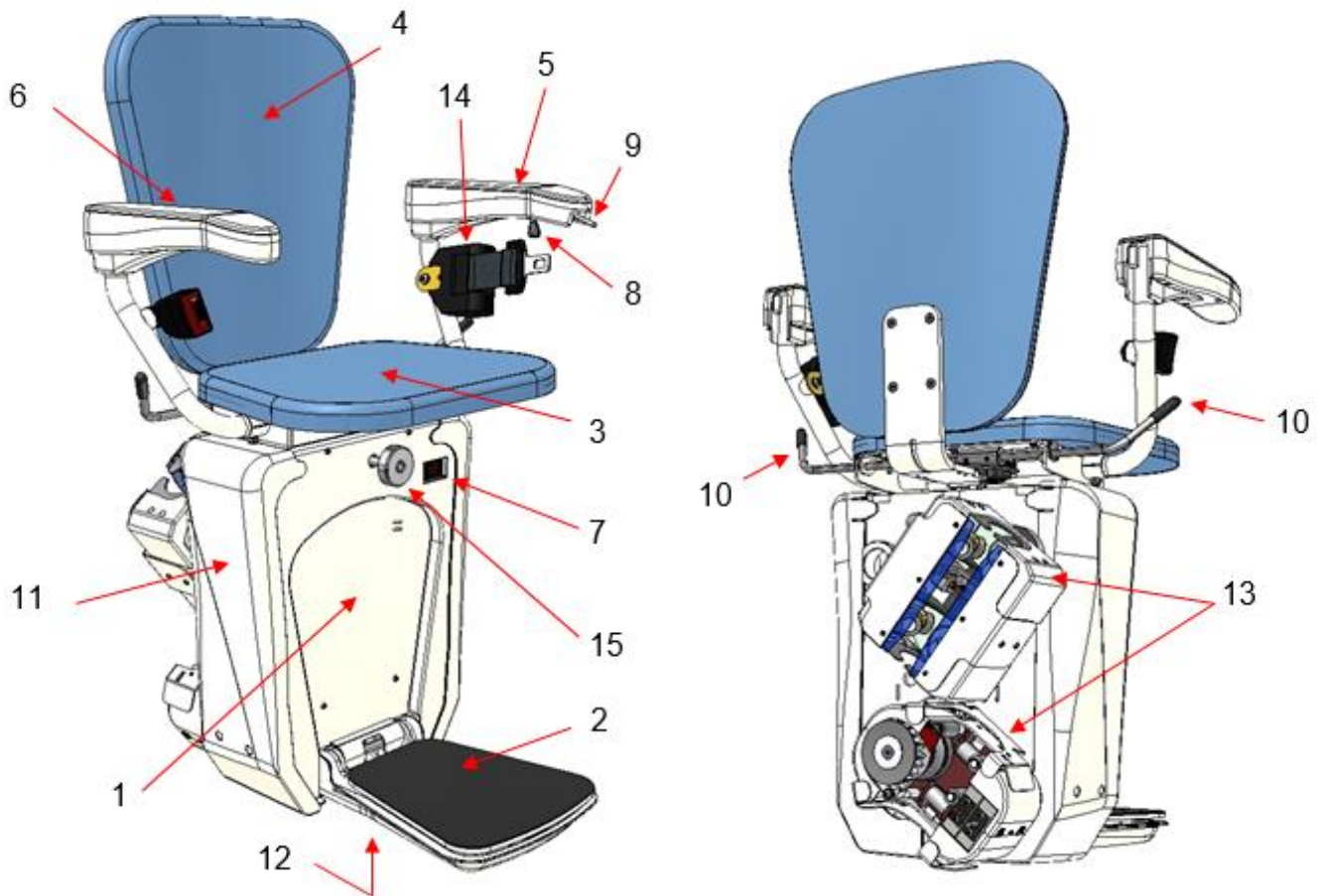

- | | | | |
|----|-----------------------|-----|-------------------------|
| 1. | Front cover | 9. | Joystick in the armrest |
| 2. | Footrest | 10. | Lever for swivel seat |
| 3. | Folding seat | 11. | Side cover |
| 4. | Backrest | 12. | Contact bottom |
| 5. | Left armrest | 13. | Drive carriage cover |
| 6. | Right armrest | 14. | Seat belt |
| 7. | Main power switch | 15. | Emergency handwheel |
| 8. | Key switch in armrest | | |

4.2 Technical specifications

Application	Private or public staircases
Driving distance	Gradients 0...52° Length up to 35 m
Load capacity	130 kg (optionally 145 kg)
Seat size	460 x 326 mm
Speed	0.11 m/s on straight runs 0.06 m/s in curves
Rail inclination	0° to 52°
Drive system	Rack
Operating elements	Joystick on the armrest and call stations at the landings
Motor	0.37 kW, 24 V direct current
Charger connection	1 x 230 V 50 Hz
Depth seat folded up	37 cm
Deep seat folded down	64.5 cm
Material rail	Steel (powder coated)
Warranty	24 months for parts
Temperature permissible	-10° C to +40° C
Batteries	2 x 12 V / 9 Ah
Seat height above footboard	496 mm
Volume	< 60 dB (A)
Certificates	TÜV according to EN 81-40

In some situations, it may be necessary to make a special adjustment to the stairlift, which may alter the above specifications.

5 SAFETY DEVICES

The *Alpha* stairlift is equipped with the following safety features:

5.1 Armrests

The armrests, which must be closed (horizontal) or folded up while driving empty, prevent falling from the chair and act as support for getting in and out of the chair in the landings.

5.2 Contact bottom

The contact bottom is attached to the underside of the footrest and serves as an additional safety feature. It reacts to pressure so that the system stops immediately if the footrest hits an obstacle. The travel command in upward direction remains active.

5.3 Lateral covers on the drive and carriages

Contact-sensitive covers are fitted to the sides of the drive and the carriages, which prevent jamming in the direction of travel. The travel command in the opposite direction remains active.

5.4 Emergency stop (optional)

The stairlift can be equipped with an emergency stop button. If you need to stop the stairlift in an emergency, press the red button and the lift will stop. Unlocking is done by pressing it again or turning it clockwise.

5.5 On/Off switch

The stairlift is fitted with an on/off switch. When the lift is not in use, this switch should be turned off.

5.6 Alarm button (optional)

The stairlift can be equipped with an alarm button to summon help. Pressing the alarm button will sound a loud emergency signal.

5.7 Speed limiter and safety gear

The stairlift is equipped with a speed limiter and a safety gear. If the stairlift descends at an increased speed (e.g. due to a defect or similar), the increased speed is immediately detected by the overspeed governor and the safety gear is triggered. The safety gear brings the stairlift to a stop by holding it against the rails. This prevents the stairlift from falling.

5.8 Battery charging system

The drive motor of your *Alpha* stairlift is powered by batteries which are charged via a charger. Charging takes place at each stop via charging contacts. When the stairlift is not in use, it is therefore necessary to always park the stairlift in the landing.

To prevent accidental parking outside a loading bay, an acoustic signal has been installed in the stairlift:

5.8.1 The beeper



If the stairlift does not park exactly on the loading point after use, the lift will give a short beep every second after 5 seconds. Then please move the lift to a stop (where it will also stop automatically) and the beep will stop.



If the stairlift parks correctly in the charging position and the lift starts to beep briefly every second, this means that the battery charging process has been interrupted. Turn off the main switch on the stairlift (the lift will stop beeping) and check if there is a power failure in your building or if the fuse or RCD in the stairlift power supply circuit is not in order. Replace the fuse or switch on the RCD and then the main switch. If the lift continues to beep, please call the service department, it could be that the battery charger is faulty.



If the battery voltage for the travel drive of the lift becomes too low, a long beep sounds every 2.5 seconds while the lift is travelling. Drive the vehicle to the charging station, where the batteries will recharge. If the lift beeps while driving even after charging the batteries, the batteries are defective. The batteries must now be replaced by the service department. If the stairlift continues to operate despite weak batteries, the stairlift control is programmed so that the stairlift will definitely reach the lower landing with the remaining battery voltage.

6 OPERATING ELEMENTS

6.1 The main power switch

The main power switch connects the system to the mains. It is located at the front of the drive.

The main power switch must be switched on so that the system can be operated. With this switch, the power can be switched off on the entire system and the control unit.



6.2 Operating elements

The chair lift is operated by the joystick in the armrest or by the up and down buttons of the call points. The optional key switch in the armrest or in the call station must be switched on to operate the chair.

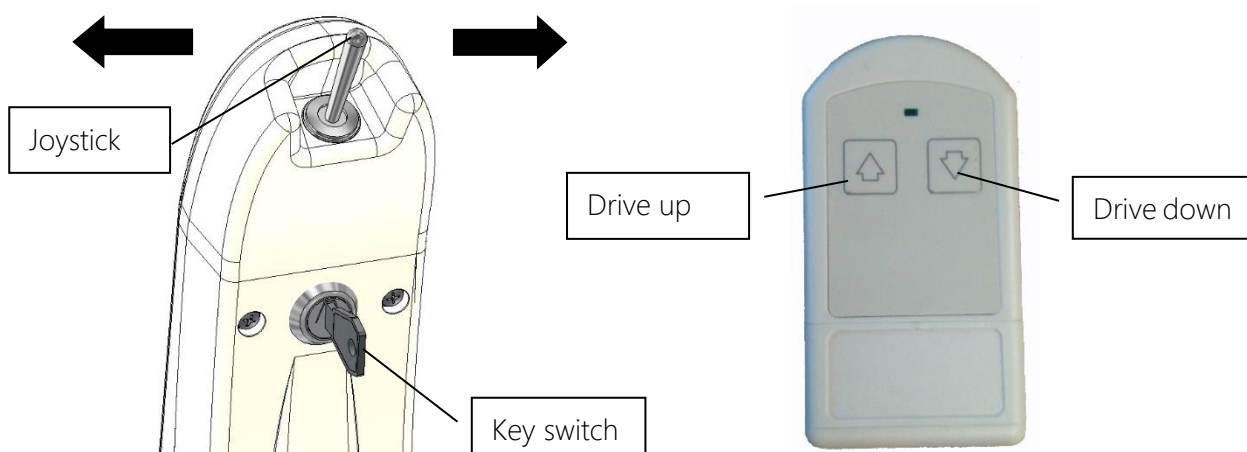

The status of the radio remote control can be read from the LED:

LED light	Description
Green glow	Radio connection available and move command active
Orange glow	Radio connection present and lift does not move Possible reasons: <ul style="list-style-type: none"> e.g.: The lift is already at the top floor Safety circuit interrupted
Red glow	Radio connection available, but the lift is busy. Lift is operated from seat or from another call station.
Green flashing	Radio transmitter has been successfully registered with the receiver
Orange flashing	Radio connection interrupted
Red flashing	The battery of the radio transmitter is weak and should be replaced.

7 OPERATION OF THE LIFT

The *Alpha* stairlift is safe and easy to use. The operation is designed for a user with walking difficulties.



Before moving the lift, make sure that nobody is endangered by the movement of the platform. If a dangerous situation arises while the platform is moving, stop the platform immediately by releasing the command!

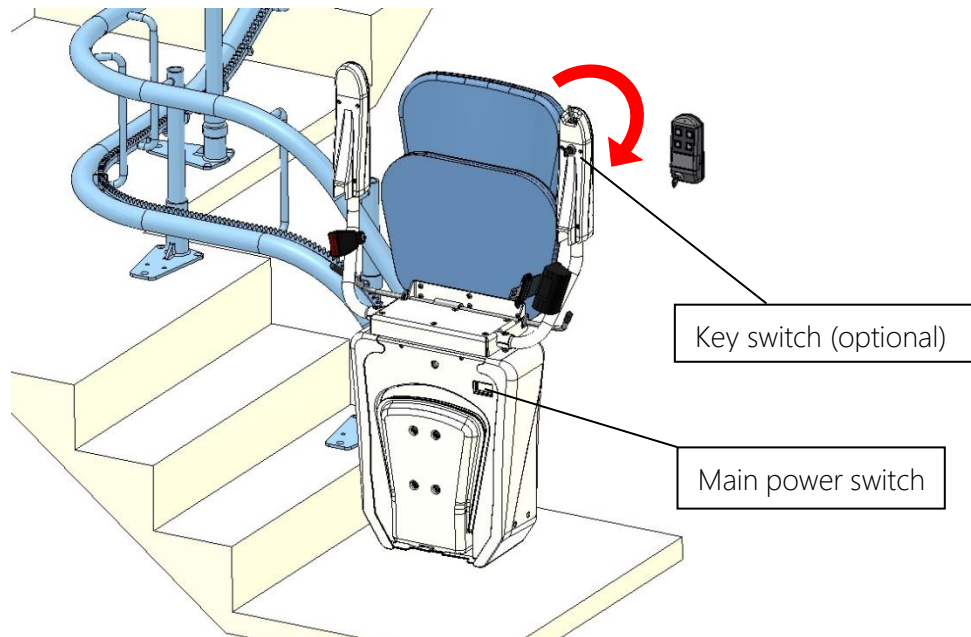

- 1) Switch on the main switch and the key switch (optional) on the armrest.
- 2) Fold down the footrest, the folding seat and armrests.
- 3) Sit on the chair with your feet on the footrest and close the belt
- 4) Press the joystick in the desired direction of travel. After 2-3 seconds the chair will start moving (safety time delay).



- 5) The stairlift runs as long as the joystick is pressed and stops automatically at the stop.
- 6) Please always look in the direction of travel!

7.1 Automatic footrest function

If the lift is equipped with an optional automatic footrest folding, you can unfold the footrest comfortably before or after being seated. The footrest movement is activated by pressing of the button on the side of the armrest.

If you choose to first sit down, open your legs about 30cm when sitting on the chair and press the button on the side of the armrest. The footrest will now fold down automatically.

When you exit the seat, you can comfortably fold up the footrest by pressing again the button on the side of the armrest.



7.2 Calling and sending the stairlift

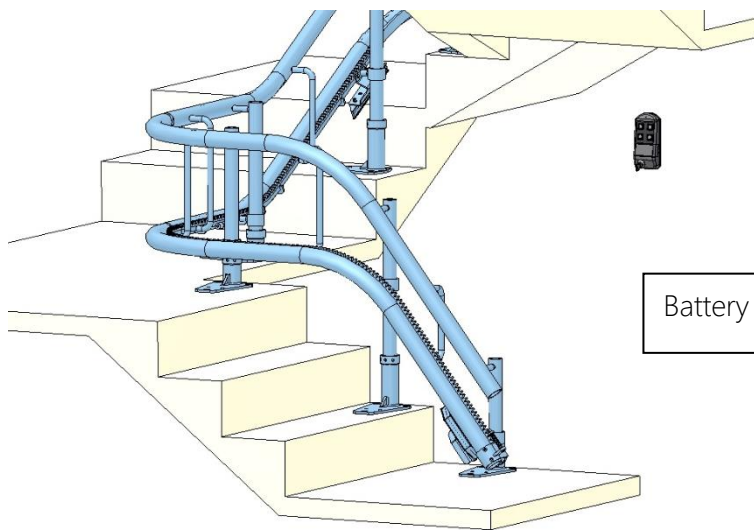

Battery cover

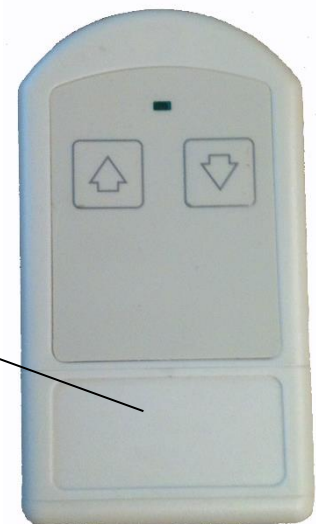

- 1) Make sure that no one is using the lift and no one is on the stairs.
- 2) Now you can call or send the lift with the up or down button on the call stations.
- 3) The chairlift runs as long as the drive command button is pressed and stops automatically at the stop.

Call stations are supplied with 2 x 1.5V AAA batteries. The service life of the batteries is approx. 1 year. The batteries can be replaced during the annual maintenance.

If the green LED light stops flashing when the buttons are pressed, the batteries must be changed.

7.3 Rotating the seat with a manual swivel seat

On the upper landing, the seat can be manually rotated (swivelled) into different positions for easier entry or exit.

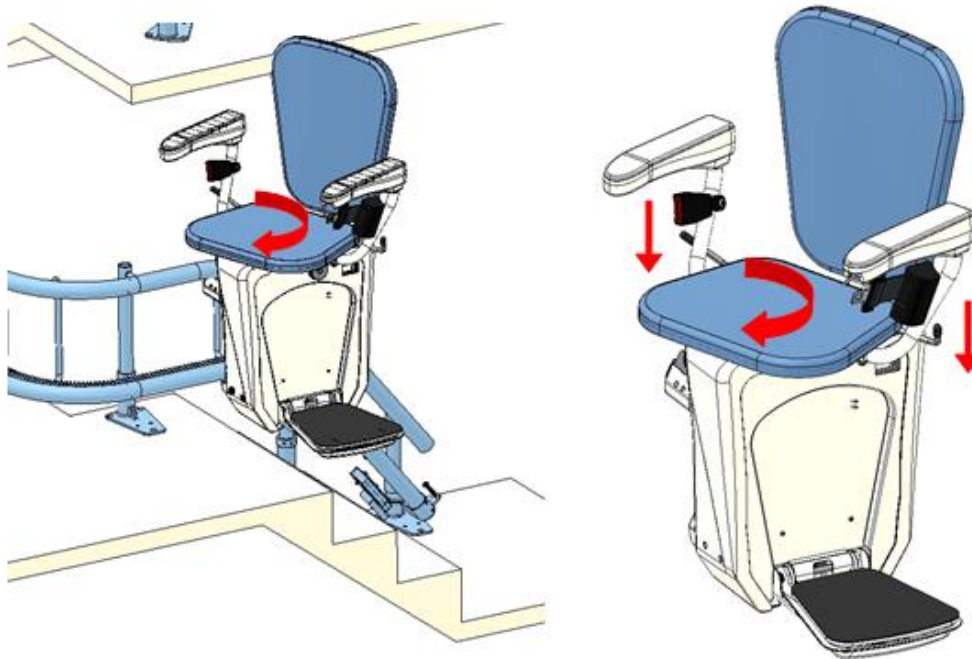

- 1) Push the lever down. The levers are located on the side of the chair, behind the armrest supports.
- 2) Turn the seat in the direction of the exit
- 3) There are 5 different positions at 0°, 20°, 45°, 70° and 90° rotation. At the desired rotation, pull the lever back up and make sure that the lever snaps back into place and fixes the seat in this position!
- 4) Leave the chair.
- 5) Turn the seat back to the driving position and pull the lever firmly upwards so that it engages again.
- 6) If desired, you can now fold up the footrest and the armrests and park the lift in this way.
- 7) Remove the key (optional) from the armrest to prevent unauthorised persons or children from using the lift.
- 8) The platform must be folded to release the lift for other users. Thus, the call stations become active again and the lift can be sent or called to a desired location.



Always make sure that the lever is in locked position (pulled downwards) after swivelling, especially when the lift is parked.

7.4 Rotating the seat with the automatic swivel seat

In the case of an automatic swivel seat, the call stations are equipped with 2 additional buttons that allow the seat to be swivelled automatically on an intermediate or the upper landing.

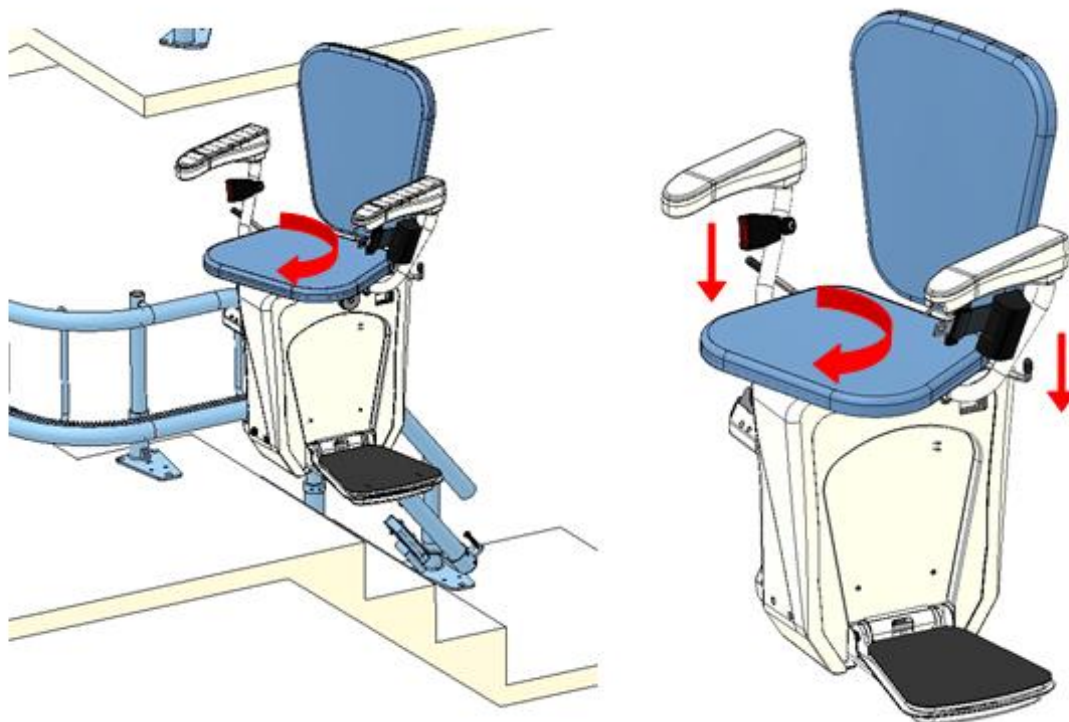
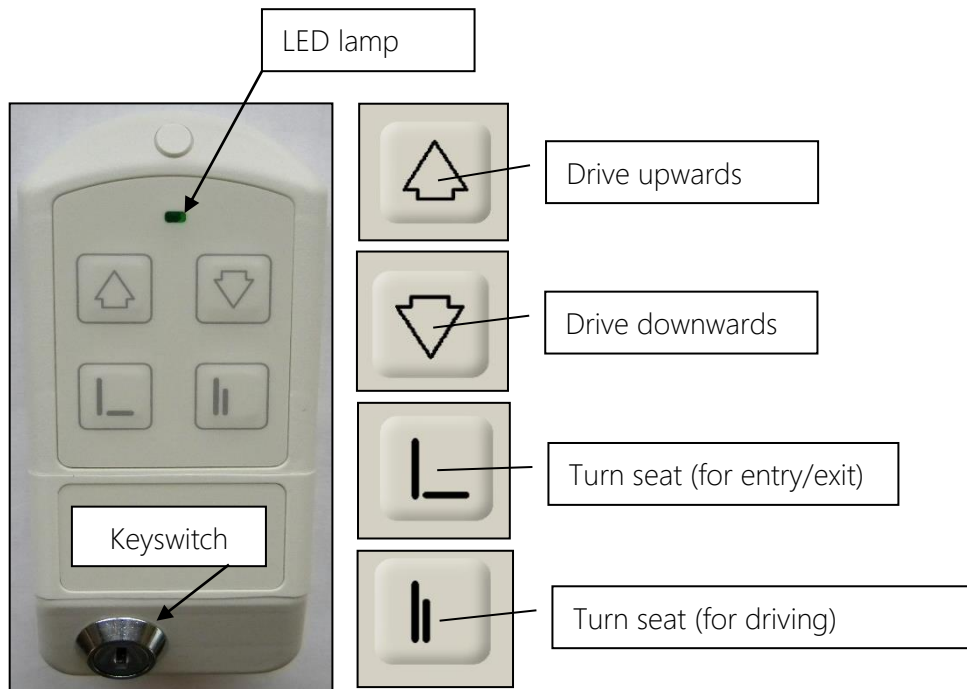

- 1) When the lift arrives at the stop, keep the joystick pressed in the direction of travel. After a short delay, the seat will start to turn automatically. Wait until the seat has turned completely and stops.
- 2) Leave the seat.
- 3) Turn the seat back by pressing the button on the call station.
- 4) Now you can fold up the seat, footrest and armrests.

7.5 Passing through an intermediate stop with automatic swivel seat

If you do not want the seat to start turning in an intermediate landing, release the joystick briefly as soon as the seat stops in the intermediate landing stop. Now you can press the joystick again and the lift will continue in the desired direction.

8 FOLDING RAIL

If the unit is equipped with a folding rail, please read the following points carefully:

- Before the folding rail can be used, the key switch on the control station must be in the "ON" position
- The folding rail can be operated by means of a joystick on the armrest or with the additional remote control supplied for the folding rail.

8.1 Journey from the lower to the upper stop

- If you want to move from the lower to the upper landing, the lift stops automatically at the loading station, which is installed after the folding rail. Now press and hold the joystick upwards so that the rail folds in completely and the lift can continue to move upwards.
- The stairlift can also be manoeuvred by remote control. To do this, press the "Drive up" button. The lift then stops after the folding rail at the loading station. Now activate the folding of the rail by pressing the "Fold" button on the additional remote control of the folding rail. After it has been folded, you can now park the stairlift at the charging station or continue the journey to the upper stop without any problems.

8.2 Journey from the upper to the lower stop

- If you want to move from the upper to the lower stop, press the joystick down. The lift stops automatically on the loading station in front of the folding rail. Now keep the joystick pressed down so that the rail opens, and the lift moves to the lower landing.
- The stairlift is located in the upper landing and is called down with the remote control. At the loading station in front of the folding rail, it stops automatically. Now press the "Unfold" button on the additional remote control of the folding rail until it is fully opened. The ride down to the lower stop works with the operation for the lift, to do this, keep the "Ride down" button pressed.

8.3 Emergency release of the folding rail

In the event of a technical failure, you can fold and unfold the folding rail manually. To do this, you have to press the red button to be able to remove the black bolt.

ATTENTION: The drive is now no longer connected to the rail and will fall down immediately! After the bolt has been removed, the folding rail can be opened and closed manually. To leave it in the folded position, bring the retaining (holding) bolt into the correct position.

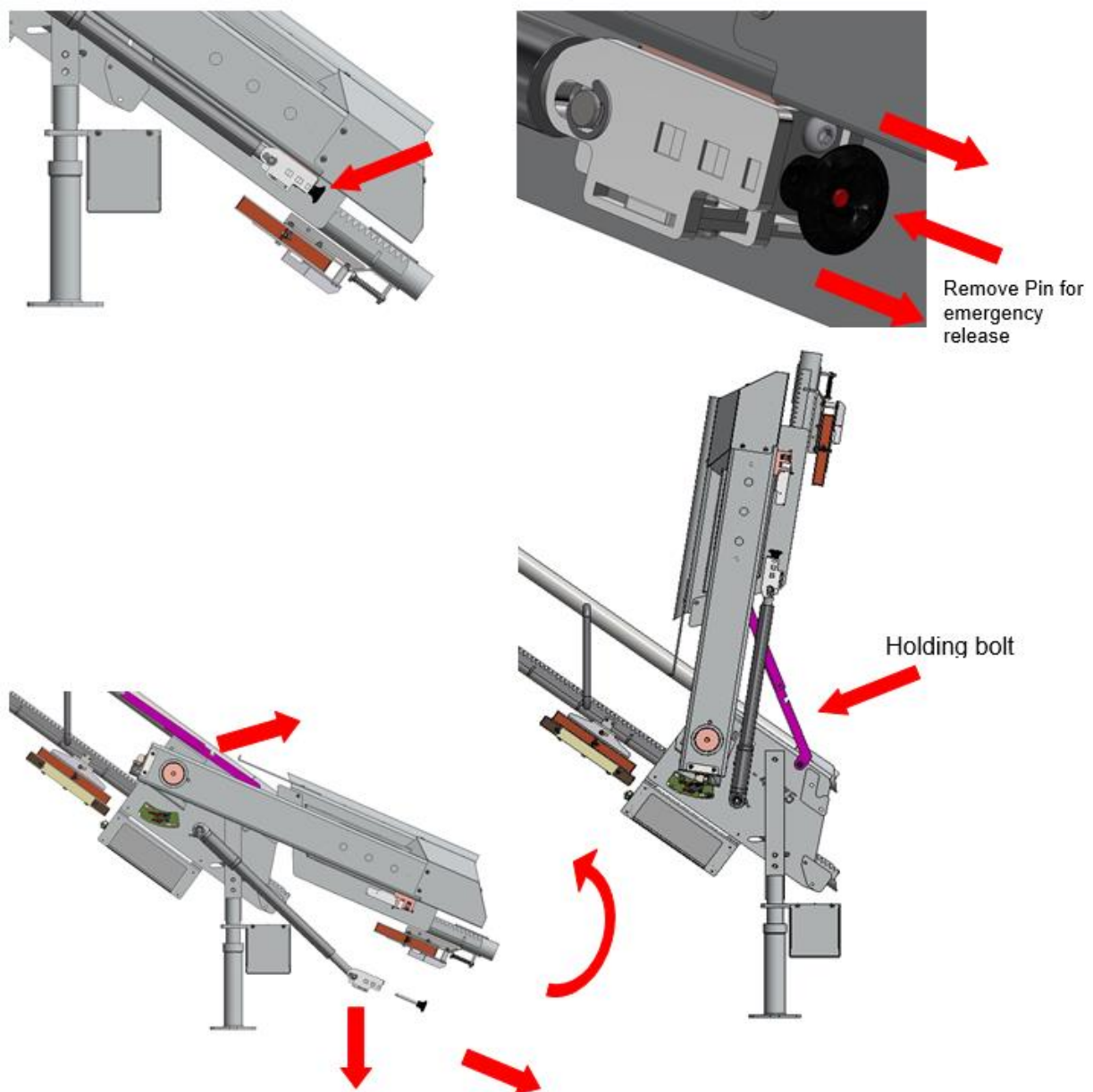

9 MALFUNCTION AND TROUBLESHOOTING

The lift is equipped with a variety of electrical and mechanical safety devices. If the lift does not function correctly, please check the following points:

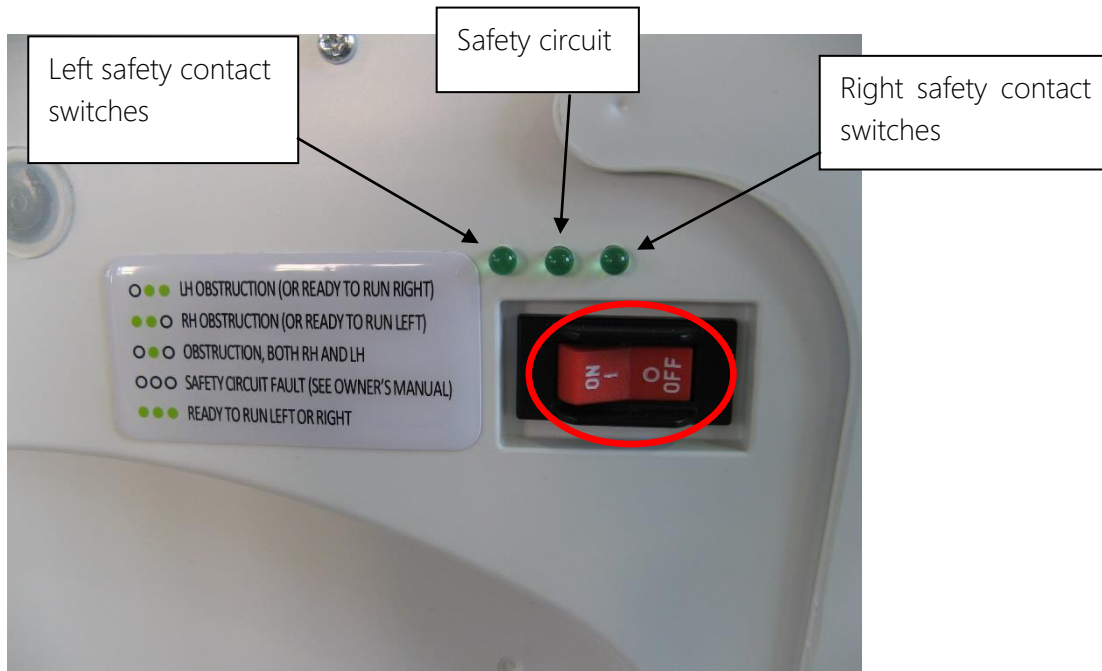

There are 3 LEDs above the main switch. The left and right LEDs provide information about the safety contact switches on the drive unit. The LED in the middle provides information about the safety circuit. If all 3 LEDs are off, the safety circuit is open.

The safety circuit consists of the following switches:

- Switch for safety gear S10
- Swivel seat switch SR2
- Emergency limit switch S22
- Switch for emergency handwheel SA5

The direction-dependent safety contacts consist of the following switches (left/right):

- Upper carriage S13/S12
- Lower carriage S27/S28
- Side switches on drive unit SK-1/SK-2
- Footrest (lateral) EK-R/EK-L
- Footrest and under the driving unit (pressure sensitive when driving downwards) S17

If all 3 LEDs are off and **the lift does not respond to the call stations or via the joystick on the armrest, please check the following points:**

- Check if all 3 LEDs are on. If not, the safety circuit is interrupted (swivel seat switch, safety gear switch, emergency hand wheel switch or emergency limit switch).
- Check that the battery is connected correctly
- Check that the main power switch is turned on.
- Check that the lift is in the correct position and not turned. The swivel seat switch must not be pressed! If it is pressed, LED 18-23 are off.
- Check that the emergency handwheel switch is not pressed.
- Check whether the safety gear has been triggered. If so, please notify the installation company.
- Check whether the emergency limit switch has been pressed. If so, please notify the installation company.

The lift only responds via the call stations, but not via the joystick on the armrest:

- Check that the armrest has been folded down completely and that the key switch in the armrest has been switches ON (optional).

The lift only responds via the joystick on the armrest, but not via the call stations:

- Check whether the LED on the call stations flashes green. If the call station flashes orange, the receiver cannot receive the signal.

The lift only goes in one direction:

- Check the left and right LEDs next to the main switch. If either LED is off, check the safety contact switches on that side.

A beep sounds on the lift (every 5 seconds outside the charging station) although it is in the charging position and LED 6 is off:

- Check that the charging pin has contact with the copper on the charging cam.
- Check that the charger is connected and that no fuse has blown.

10 MOVEMENT OF THE LIFT WITH EMERGENCY HANDWHEEL

If the lift stops on the stairs and cannot be moved any further, then you can move it to the next landing or outside the walking area with the emergency hand wheel.

The handwheel is inserted through the front plastic cover. This opening is next to the main switch.

The hand wheel must be pressed into the hole with a little pressure and then turned. You can only move the lift very slowly in this way.

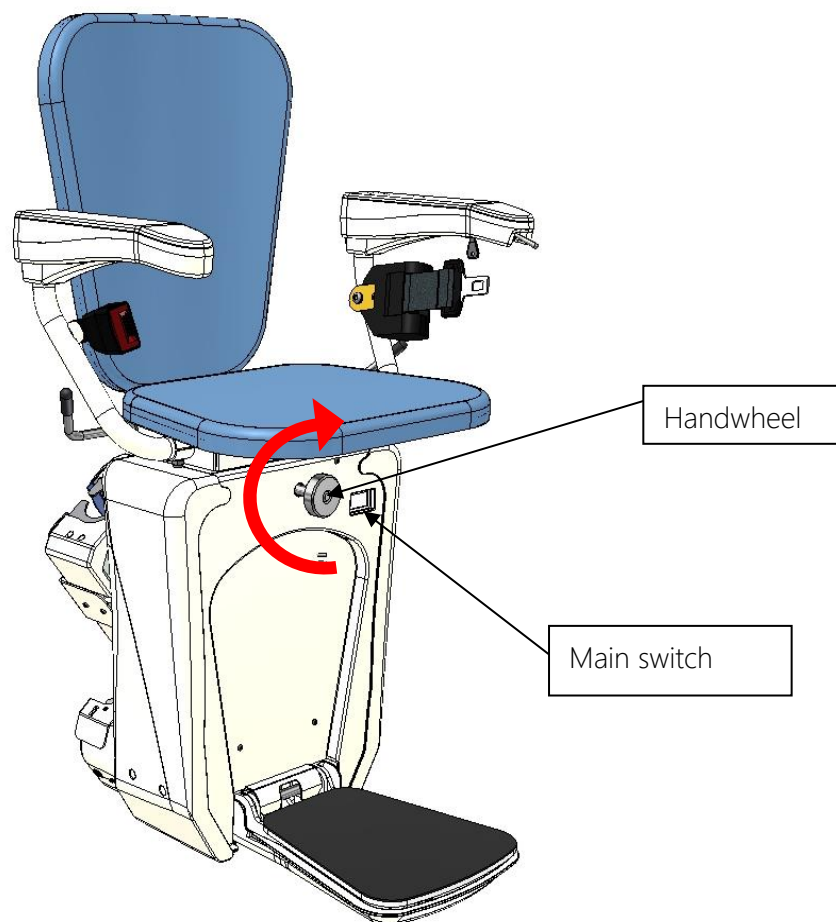

As long as the handwheel is inserted, the safety circuit is cut and the lift cannot operate!
Remove the handwheel before restarting the lift.

11 CONTROL AND MAINTENANCE

11.1 Security checks

Check the following points regularly, but at least daily:

- The lift must not start as long as the ramps or barriers are open. During travel, the barriers must be closed and the ramps folded up.
- If a raised drive-up flap hits an obstacle, the lift must stop immediately. The connecting linkage between the hoop barriers and the flaps, which leads into the side wall, must be in perfect condition (securely screwed on, no rope breakage).
- The hoop barriers must not be open while driving (test in the middle of the lane).
- The stairlift must stop independently when reaching the stops.
- When the run command is released, the stairlift must stop without a longer run-on distance.
- The emergency stop button must shut down the entire system when pressed.
- If an emergency call is available, it must always work.

11.2 Cleaning

Clean the unit at regular intervals to remove dust and dirt. Please observe the following points:

- For safety reasons, the lift must always be taken out of operation before cleaning.
- Never use cleaning agents that require special ventilation.
- Do not use aggressive cleaning agents to clean plastic-coated or painted surfaces.
- Stainless steel surfaces should be treated with a commercially available cleaning agent (stainless steel care spray, slightly greasing), do not use scouring powder.
- The push buttons must never be treated with cleaning sprays or the like (sticking of the buttons is possible!). The floor should be wiped with a damp dust rag.
- Avoid wetness, especially with the operating elements (no splashing water)!
- Further maintenance work may only be carried out by employees of the manufacturer or its authorised partner companies !

12 MAINTENANCE / INSPECTION

To ensure that your stairlift continues to operate safely and trouble-free over a long period of time, regular professional maintenance, care and cleaning on the one hand and regular safety checks on the other are absolutely essential. Good maintenance and care significantly increases the service life and offers users the highest possible level of safety.

Maintenance of your stairlift is essential. The prescribed maintenance intervals are as follows (even with low usage):

- First maintenance approx. 6 months after commissioning
- All other maintenance at least once a year

We recommend that you conclude a technical maintenance contract with your installation company. You will receive a maintenance quotation for your stairlift which is specifically adapted to the type of use of your platform and your needs.

12.1 Review



Please ask your installation company whether the stairlift has to be inspected by a civilian expert or the TÜV after installation. These inspections must be documented in an inspection book.

12.2 Maintenance instructions

At each maintenance, the rectified defects are to be entered in the maintenance book. Any faults or indications of faults must be discussed with the operator of the lift system. Each maintenance must be recorded in the maintenance book of the respective system with date and signature.

Carefully check the fastening of the bolted connections of the entire installation to the staircase. Carefully check any fastenings holding the parts of the installation together - tighten every nut, bolt and screw.

Check smooth ascent and descent along the entire length of the installation, as well as stopping at the end stations several times. This should be checked from the radio controls as well as from the stairlift and when fully loaded.

Check the following points in detail:

12.2.1 Stairlift controls

- Main switch (ON/OFF) on the side of the trolley
- Emergency stop on the seat (optional)
- Up and down radio control
- Up and down from the control on the armrest
- Key switch of radio control (optional)

12.2.2 Mechanics of the swivel seat, footrest and armrests

- Remove the covers and check all mechanical parts (swivel seat, footrest and armrest) for ease of movement. If necessary, apply a thin film of lubricant sparingly.

- The setting and function of the mechanical interlock on the swivel seat and its contact switch must be checked.

12.2.3 Contact base and contact-sensitive covers

- Check correct stopping when actuated and travel in the opposite direction when activating the contact bottom (travel OPEN) or the side contact-sensitive covers

12.2.4 Safety gear / Speed limiter

- Carefully check the safety gear and its connecting elements for ease of movement and secure anchoring.
- Ensure correct setting
- Test the engagement of the safety gear at least once a year.

12.2.5 Rails / rack

- Visual inspection of the rack and track for wear or damage.
- Grounding the roadway

12.2.6 Carriage rollers

- Visual inspection for wear and control of the play
- Checking the roller guides for bearing noise and wear

12.2.7 Fastening of the rail and the supports

- Check fixings to wall/floor/ceiling and check fixings between pipes and supports. Tighten loose bolts and screws.
- Check the connecting screws between the track parts for tightness.

12.2.8 Mechanical switches

- Check all mechanical switches (position switches, limit switches in the stops, emergency limit switches up and down, catch switches, etc...) for their function and sufficient play of the rollers.
- Check all fastening and actuating elements of the forced switches for secure hold.

12.2.9 Gearbox and drive motor

- Checking the wear of the drive gear on the drive
- Checking the adjustment and wear of the brake (holding accuracy, ease of play)
- Check engine mounting for firm anchorage
- Check for unusual noises and vibrations
- Check the function of the emergency handwheel crank. Note that the engine brake must be opened manually.

12.2.10 Signalling equipment

- Acoustic signal for battery charge levels
- Visual signal (if available)
- If available - check the voice connection to the rescue personnel.

12.2.11 Documents / Emergency release key

- Are all technical documents available (circuit diagrams, setting instructions, operating instructions, etc.)?
- Is there an emergency handwheel?

12.3 Lubricants and operating fluids, spare parts

12.3.1 Lubricants and operating fluids

- Rails - Lubrication of the guide rails is not necessary
- Impellers - Lubrication of the impellers is not required
- Joints - Joints and sliding surfaces must be lubricated with engine oil or with suitable greases.
- Preservative - The chains can be treated with a preservative to protect them from corrosion
- Cleaning agents - Do not use aggressive cleaning agents to clean plastic-coated or painted surfaces.

12.3.2 Spare parts

Only original spare parts from Lehner Liftechnik may be used, as this is the only way to guarantee safety and functionality. If other products are used, the declaration of conformity loses its validity.

13 INSTALLATION AND COMMISSIONING

The system may only be set up and commissioned by a partner company trained by Lehner Liftechnik GmbH. When setting up the lift, it must be ensured that no impacts or vibrations from neighbouring machines have an effect on the system. This could affect the electronics or the precision mechanics of the lift. The load-bearing capacity must be checked on the basis of the support load per unit area and the resulting force distribution on the wall by a state-certified structural engineer.

13.1 Fixing the rail system

The detailed installation drawing for your system is in the box we supply. This box also contains the charger and the corresponding controls (radio wall switch, hand transmitter or cable remote control). For more detailed information on installation, please refer to the installation instructions.

If you have any problems or questions, contact your Lehner Liftechnik partner or customer service immediately. Installation work on the entire system may only be carried out by the manufacturer or its authorised partner companies. Failure to do so will invalidate the operating permit. The exclusion of liability for consequential damage of any kind is effected.

13.2 Dismantling and disposal

Dismantling work on the entire system may only be carried out by the manufacturer or its authorised partner companies. The exclusion of liability for consequential damage of any kind is effected.

According to the European Directive 2002/96/EC on Waste Electrical and Electronic Equipment and its implementation in national law, used electrical equipment must be collected separately and recycled in an environmentally sound manner.

14 CE DECLARATION OF CONFORMITY



The manufacturer: Lehner Liftechnik GmbH
Salling 8
4724 Neukirchen am Walde, Austria

hereby declares under its sole responsibility that the machine described below:

Designation: Seat stair lift for persons with reduced mobility
Type and commercial designation: *Alpha*

whose data are described in the user manual, complies with European directives by having all the necessary safety features and thus eliminating risks as far as possible.

Applied European directives:

2006/42/EC (Machinery Directive), 2014/35/EU (Low Voltage Directive),
2014/30/EU (EMC Directive), 2014/53/EU (Directive on the Making Available of Radio Equipment)

Applied standards:

EN ISO 12100:2010	Safety of machinery
EN ISO 13850:2015	Safety of machinery - Emergency stop - Principles for design
EN 60204-1:2019	Safety of machinery - Electrical equipment of machines
EN 300 220-1	Radio systems with short range
EN 301 489-1	Electromagnetic compatibility for radio equipment and services
EN 81:40:2020	Safety rules for the construction and installation of lifts - Special lifts for the transport of persons and goods - Part 40: Inclined stairlifts and inclined platform lifts for persons with disabilities

For the product as delivered from the factory.

The technical documents managed:
Lehner Liftechnik GmbH
Salling 8
4724 Neukirchen am Walde, Austria

This declaration becomes invalid if the machine is modified or altered or if the provisions of the "Alpha - User Manual" are not observed.

Lehner Christian
Managing Director

Neukirchen am Walde,
03.04.2023

15 DUTIES OF THE STAIRLIFT OPERATOR

If prescribed, the system may only be put into operation after acceptance by a civil technical expert and presentation of a defect-free expert report! Otherwise, safe operation cannot be guaranteed!

Always make sure that an instructed person is available next to the user. The user must be able to reach this person easily in order to ensure that he/she can be rescued in an emergency (e.g. technical defect).

If an emergency call system for summoning help is installed, it must be checked regularly, but at least once a week, to ensure that it is functioning properly.

If external help is summoned (e.g. by telephone), an access possibility for the summoned help personnel must be created.

The system operator is obliged to ensure adequate maintenance of the system. It is therefore of particular importance that a scheduled maintenance service is established with a maintenance company before the stairlift is put into service.

Maintenance must be entrusted to competent persons to ensure the comprehensive safety of the stairlift. General maintenance instructions can be found in the relevant chapter of this operator's manual.

The use of the system must be strictly limited to the specified purpose.

The operator's manual shall be kept in a suitable place which is accessible to all authorised persons in case of need.

Safe access to the building and the stairlift must be ensured at all times, especially for emergencies, to carry out maintenance work or inspections.

Irregularities during operation or emergency situations must be reported immediately to the maintenance company. In addition, the maintenance company must be informed of all changes to the building and the system that could affect operation.

16 REQUIREMENTS FOR THE MAINTENANCE COMPANY

A maintenance company in the sense of this manual, which meets all requirements, must fulfil the following points:

- A maintenance company must have sufficient qualified personnel for maintenance work and troubleshooting.
- Maintenance personnel must have appropriate training and experience in the area being used.
- Regular training and further education of these personnel must be ensured.
- The maintenance company must provide the operator with a maintenance plan adapted to the system in order to ensure the greatest possible availability and safety of the system.
- The maintenance company must take the plant-specific maintenance work into account in its maintenance plan and ensure that this work is carried out.
- The company and its maintenance personnel must have sufficient technical equipment to carry out all required activities safely.
- The maintenance company must have all necessary original spare parts quickly available at all times.
- The maintenance company must inform the operator about the condition of the system and about any repair work.
- The maintenance company, in cooperation with the operator, must ensure the observation of the system in order to detect changes in the operating behaviour and to initiate necessary maintenance or repair work.
- The maintenance company must have appropriate and sufficient insurance cover.
- The maintenance company must record every intervention that occurred due to a fault.

